



Brighton International Best TEE Bolts



TEE
Bolts



TEE BOLTS

Metric

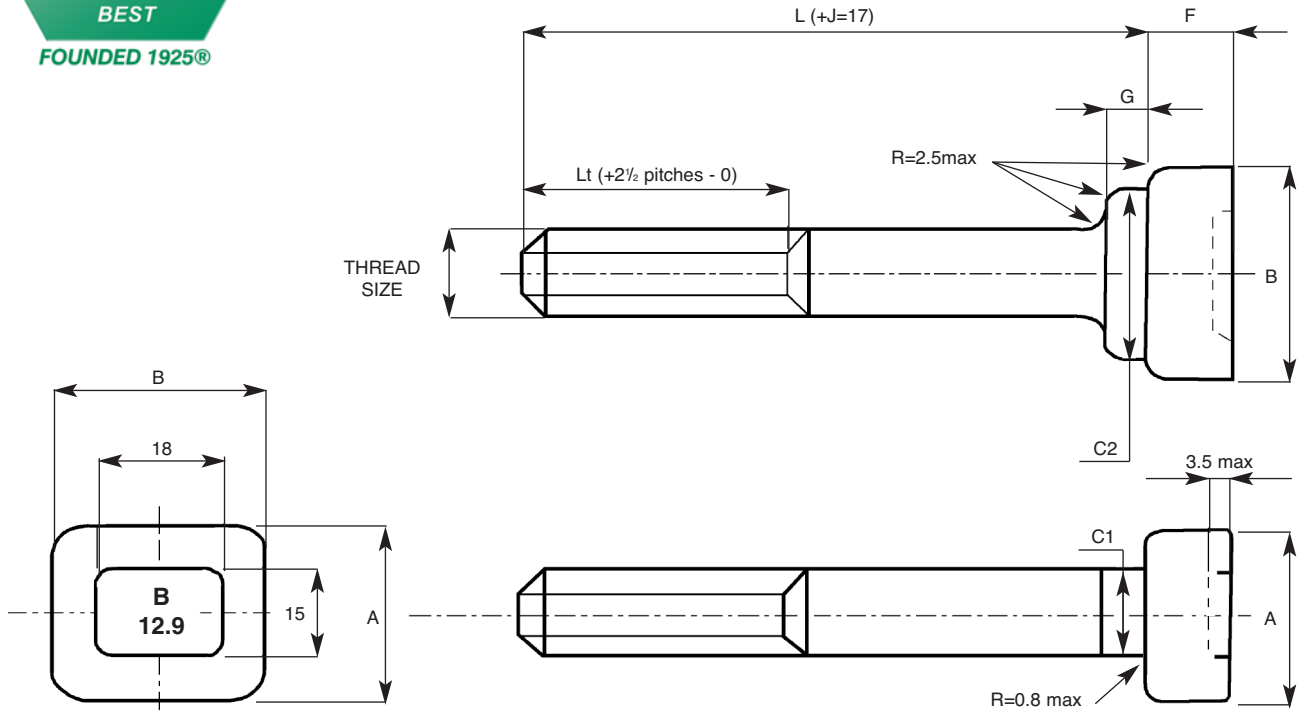

ALL DIMENSIONS IN MILLIMETRES

DIMENSIONS - ISO METRIC THREADS

THREAD SIZE	A (h14)	B (+0 - 2.00)	C1 (+0 - 0.30)	C2 (Js 17)	F (h15)	G (h15)
M12 (1.75)	21.00 (-0.52)	26.00÷24.00	12.00÷11.70	21.00±1.05	7.10 (-0.58)	4.60 (-0.48)
M16 (2.00)	27.00 (-0.52)	32.00÷30.00	16.00÷15.70	28.00±1.25	9.40 (-0.58)	6.35 (-0.58)
M20 (2.50)	34.00 (-0.62)	40.00÷38.00	20.00÷19.70	35.00±1.25	14.00 (-0.70)	10.00 (-0.58)
M24 (3.00)	42.00 (-0.62)	48.00÷46.00	24.00÷23.70	42.00±1.25	16.00 (-0.70)	10.00 (-0.58)

THREAD LENGTHS - ISO METRIC THREADS

THREAD SIZE	NOMINAL LENGTH - L																															
	40	45	50	55	60	65	70	80	90	100	110	120	125	130	140	150	160	170	180	190	200	210	220	230	240							
	LENGTH OF THREAD - Lt																															
M12 (1.75)	25			30		35	40																	45								
M16 (1.75)	-	30				35	40	45																	54							
M20 (2.50)	-							35	40	45																	64					
M24 (3.00)	-						35	40	45																	75						

MECHANICAL PROPERTIES

NOTES

• Material	: High Grade Alloy Steel	1) Thread Class	: 4g - 6g
• Class 12.9	: Hardness HRC 38÷44	2) Working Temperature	: -50°C + 300°C
• Tensile Strength	: Rm ≥ 1240 N/mm ²	3) Marking	: B 12.9
• Yield Strength	: Rp (0.2) ≥ 1120 N/mm ²	4) Protective	: Light oil
• Shear Strength	: R ≥ 745 N/mm ²		
• Elongation	: A ≥ 9%		



TEE BOLTS

Whitworth (BSW)

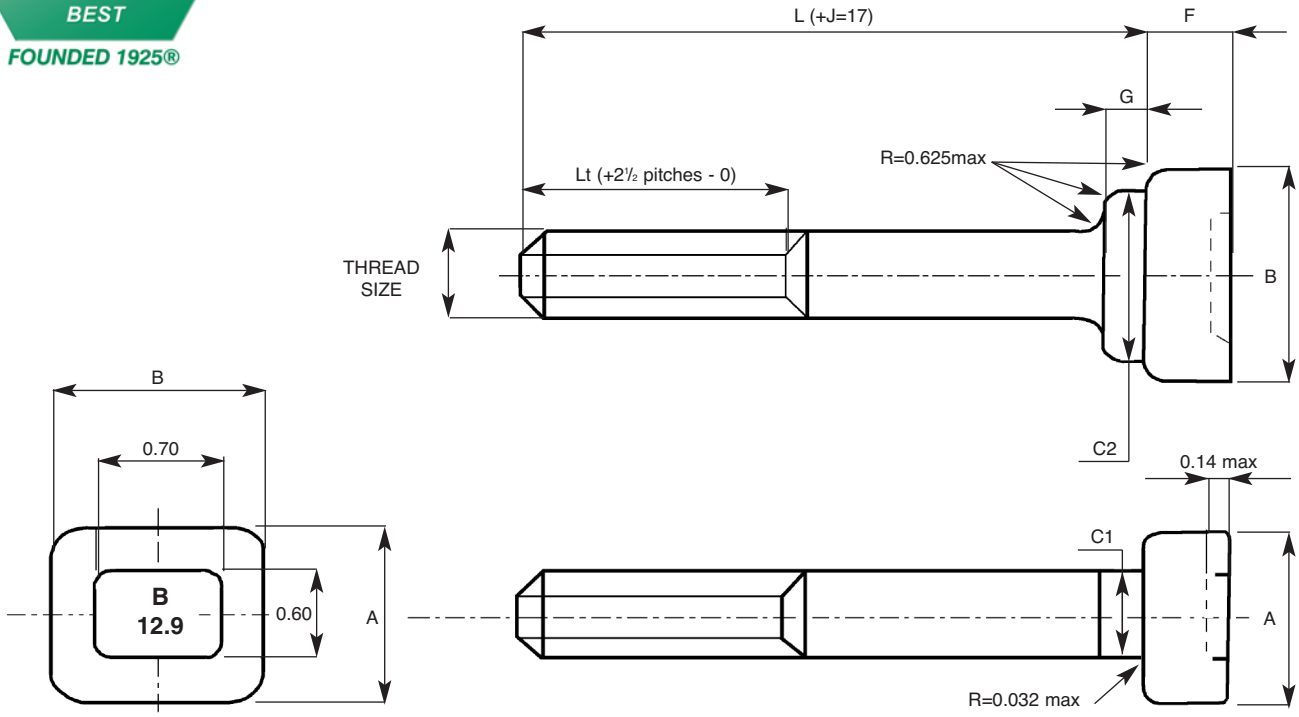

ALL DIMENSIONS IN INCHES (1 inch = 25.4mm)

DIMENSIONS - BSW THREAD															
THREAD SIZE	A (h14)	B (+0 - 0.08)	C1 (+0 - 0.012)	C2 (Js 17)	F (h15)	G (h15)									
1/2" (12)	0.87 (-0.021)	1.06±0.98	0.500±0.488	0.87±0.041	0.28 (-0.023)	0.18 (-0.019)									
5/8" (11)	1.125 (-0.021)	1.25±1.17	0.620±0.608	1.09±0.041	0.37 (-0.023)	0.25 (-0.023)									
3/4" (10)	1.32 (-0.025)	1.56±1.48	0.750±0.738	1.32±0.049	0.37 (-0.023)	0.31 (-0.023)									
7/8" (9)	1.45 (-0.025)	1.75±1.67	0.870±0.858	1.52±0.049	0.56 (-0.027)	0.37 (-0.023)									
1" (8)															
THREAD LENGTHS - BSW THREAD															
THREAD SIZE	NOMINAL LENGTH - L														
	1 1/2	2	2 1/2	3	3 1/2	4	4 1/2	5	6	7	8	9	10	11	12
	LENGTH OF THREAD - Lt														
1/2" (12)	1	1 1/8	1 1/4	1 1/2									1 3/4		
5/8" (11)	-	1 1/8	1 1/4	1 1/2	1 3/4	2 1/4							2 1/2		
3/4" (10)	-	1 1/8	1 1/4	1 1/2	1 3/4	2 1/4							2 1/2		
7/8" (9)	-	1 1/4	1 1/2	1 3/4	2	2 1/2							3		
1" (8)	-	1 1/4	1 1/2	1 3/4	2	2 1/2							3		
MECHANICAL PROPERTIES				NOTES											
• Material	: High Grade Alloy Steel			1) Thread Class	: Medium										
• Class 12.9	: Hardness HRC 38÷44			2) Working Temperature	: -50°C + 300°C										
• Tensile Strength	UTS	≥	180.000 lbf/in ²	3) Marking	: B 12.9										
• Yield Strength	YS (0.2)	≥	162.000 lbf/in ²	4) Protective	: Light oil										
• Shear Strength	USS	≥	108.000 lbf/in ²												
• Elongation	E	≥	9%												

TEE BOLTS PACK

DESCRIPTION	PACK	DESCRIPTION	PACK	DESCRIPTION	PACK
M12 x 40	25	M24 x 80	10	3/4 BSW x 2 1/2	25
M12 x 50	25	M24 x 90	10	3/4 BSW x 3	25
M12 x 55	25	M24 x 100	10	3/4 BSW x 3 1/2	25
M12 x 60	25	M24 x 110	10	3/4 BSW x 4	25
M12 x 65	25	M24 x 120	5	3/4 BSW x 4 1/2	10
M12 x 70	25	M24 x 125	5	3/4 BSW x 5	10
M12 x 80	25	M24 x 150	5	3/4 BSW x 5 1/2	10
M12 x 90	25	M24 x 160	5	3/4 BSW x 6	10
M12 x 100	25	M24 x 180	5	3/4 BSW x 7	10
M12 x 125	25	M24 x 200	5	3/4 BSW x 8	10
M12 x 160	25	M24 x 240	5	3/4 BSW x 9	5
		M24 x 280	5	3/4 BSW x 10	5
		M24 x 300	5	3/4 BSW x 12	5
		M24 x 320	5		
M16 x 40	25	1/2 BSW x 1 1/2	25		
M16 x 50	25	1/2 BSW x 2	25		
M16 x 60	25	1/2 BSW x 2 1/2	25	7/8 BSW x 3	10
M16 x 70	25	1/2 BSW x 3	25	7/8 BSW x 4	10
M16 x 80	25	1/2 BSW x 3 1/2	25	7/8 BSW x 5	10
M16 x 90	25	1/2 BSW x 4	25	7/8 BSW x 6	10
M16 x 100	25	1/2 BSW x 4 1/2	25	7/8 BSW x 7	5
M16 x 120	25	1/2 BSW x 5	25	7/8 BSW x 8	5
M16 x 125	25	1/2 BSW x 6	25	7/8 BSW x 9	5
M16 x 150	10	1/2 BSW x 7	25	7/8 BSW x 10	5
M16 x 160	10	1/2 BSW x 8	25	7/8 BSW x 12	5
M16 x 200	10	1/2 BSW x 9	10	7/8 BSW x 14	5
M16 x 240	10	1/2 BSW x 10	10		
		1/2 BSW x 12	10		
		5/8 BSW x 2	25	1 BSW x 3	10
M20 x 80	25	5/8 BSW x 2 1/2	25	1 BSW x 4	10
M20 x 90	25	5/8 BSW x 3	25	1 BSW x 5	5
M20 x 100	10	5/8 BSW x 3 1/2	25	1 BSW x 6	5
M20 x 110	10	5/8 BSW x 4	25	1 BSW x 7	5
M20 x 120	10	5/8 BSW x 4 1/2	25	1 BSW x 8	5
M20 x 125	10	5/8 BSW x 5	10	1 BSW x 9	5
M20 x 150	10	5/8 BSW x 5 1/2	10	1 BSW x 10	5
M20 x 160	10	5/8 BSW x 6	10	1 BSW x 12	5
M20 x 180	10	5/8 BSW x 7	10	1 BSW x 14	5
M20 x 200	10	5/8 BSW x 8	10	1 BSW x 16	5
M20 x 240	5	5/8 BSW x 9	10	1 BSW x 20	5
M20 x 280	5	5/8 BSW x 10	10		
		5/8 BSW x 12	10		



PHONE:
+44 (0) 121 553 4674
FAX:
+44 (0) 121 553 5024
WEB:
www.brightonbest.co.uk
EMAIL:
sales@brightonbest.org

